

BK

## INDUSTRIAL SPRAY NOZZLES - SOLID CONE

### SPRAY CHARACTERISTICS

- *Uniform distribution of droplets in a solid cone spray pattern.*
- *Impact of spray is greater with narrower spray angles, assuming the same flow rate. Pressure increases spray angle which affects impact.*

### CONSTRUCTION AND MATERIALS

- *One piece body with removable spiral-type core.*
- *Hexagon body for easy installation eliminates distortion of orifice during installation.*
- *Available with Male BSPT and Female BSPP threads.*
- *Brass and Stainless Steel are standard.*
- *Other materials available to special order.*

### ORDER EXAMPLE

*1/8" BKM (Male) 5 Brass.*

*3/8" BKF (Female) 30 Stainless Steel.*

Maximum Recommended Pressure:

70 Bar.G. (Metal), 7 Bar.G. (Plastic)



## CAPACITY CHARTS

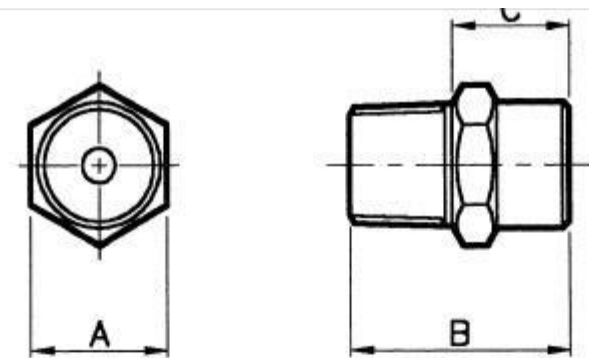

BKM (MALE)

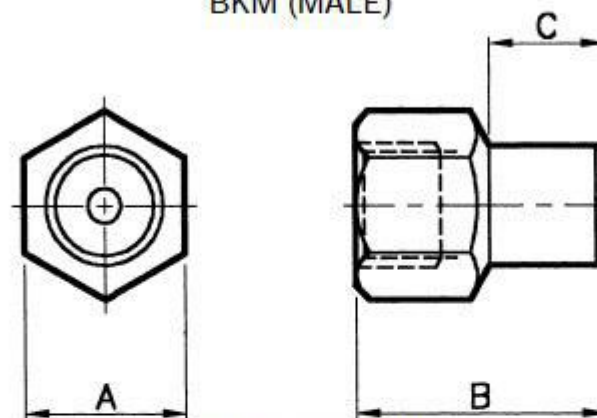

BKF (FEMALE)

### DIMENSIONS AND WEIGHTS

Thread Size	Nozzle Type	Dimensions (mm)			Weight (g)
		A Hex	B	C	
1/8"	BKM	11,3	17,5	9,6	10
1/8"	BKF	15,3	25,4	13,5	21
1/4"	BKM	15,3	24,5	13,0	24
1/4"	BKF	18,0	27,8	12,7	35
3/8"	BKM	18,0	25,5	14,0	35
3/8"	BKF	20,8	38,9	21,1	58
1/2"	BKM	25,6	32,0	16,1	75
1/2"	BKF	25,6	50,0	28,3	118
3/4"	BKM	28,0	36,0	19,0	115
3/4"	BKF	31,8	62,7	31,5	215
1"	BKM	38,0	50,0	28,5	290
1"	BKF	38,0	81,0	51,0	330

# CAPACITY CHART

NOZZLE NUMBER		Approx. Orifice Dia. (mm)	BSPT THREAD SIZE							FLOW RATE IN LITRES/MIN AT Bar.G.										SPRAY ANGLES (°) AT Bar.G.		
Female	Male		1/8	1/4	3/8	1/2	3/4	1	0,7	1	1,5	2	3	4	5	6	7	8	0,7	2	6	
BKF 5	BKM 5	1,6							1,18	1,40	1,73	2,01	2,34	2,62	2,85	3,05	3,26	3,46	25	30	30	
BKF 7	BKM 7	2,0							1,55	1,88	2,35	2,76	3,28	3,64	3,96	4,24	4,50	4,73	30	45	45	
BKF 10	BKM 10	2,8							2,09	2,51	3,11	3,62	4,25	4,82	5,28	5,70	6,15	6,47	55	65	68	
BKF 10	BKM 10	2,4							2,27	2,71	3,33	3,87	4,58	5,14	5,70	6,15	6,57	6,98	20	32	36	
BKF 13	BKM 13	2,8							2,91	3,48	4,31	5,01	6,06	6,80	7,43	8,04	8,54	9,00	23	45	47	
BKF 16	BKM 16	3,2							3,39	4,04	4,96	5,79	7,12	7,99	8,73	9,41	9,96	10,61	28	49	56	
BKF 19	BKM 19	4,0							4,22	4,96	6,11	7,03	8,59	9,92	10,91	11,82	12,73	13,53	46	70	78	
BKF 25	BKM 25	4,3							6,33	6,93	8,54	9,92	12,12	14,14	15,86	17,37	18,79	20,20	24	50	47	
BKF 30	BKM 30	4,8							6,57	7,85	9,55	11,01	13,53	15,66	17,47	19,09	20,71	22,02	55	72	65	
BKF 53	BKM 53	6,4							12,52	14,54	17,37	19,70	23,43	26,66	29,39	31,71	33,94	35,86	48	53	78	
BKF 86	BKM 86	7,1							18,08	21,82	27,27	31,92	38,99	44,04	48,18	51,91	56,06	58,78	50	64	51	
BKF 105	BKM 105	7,9							22,73	27,17	33,43	38,58	47,27	53,23	58,78	62,92	67,47	71,21	48	65	50	
BKF 120	BKM 120	9,5							27,57	32,12	38,48	43,63	51,91	58,78	65,25	70,30	75,35	79,89	60	75	98	
BKF 144	BKM 144	10,3							33,03	38,58	45,96	52,32	62,42	70,70	78,07	84,44	90,50	96,46	67	83	100	
BKF 162	BKM 162	9,5							37,17	43,53	52,32	59,19	71,21	80,80	89,49	96,86	104,03	110,09	75	86	66	
BKF 179	BKM 179	10,3							39,29	45,96	55,55	62,92	75,75	84,44	96,46	104,03	112,11	119,18	77	90	70	
BKF 204	BKM 204	11,1							45,96	53,23	63,83	72,52	86,76	98,68	109,08	118,17	126,25	134,33	78	93	70	
BKF 217	BKM 217	11,9							50,50	58,78	70,30	79,39	95,04	108,07	119,18	129,28	139,38	146,45	90	95	77	
BKF 252	BKM 252	12,7							58,28	68,38	81,71	93,22	111,10	126,25	139,38	151,50	162,61	172,71	90	105	85	