

CA

INDUSTRIAL SPRAY NOZZLES - SOLID CONE

SPRAY CHARACTERISTICS

- *Uniform distribution of droplets in solid cone spray pattern.*
- *Droplet size is larger than in hollow cone nozzles of equal capacity.*
- *Spray droplet size increases as flow increases at the same pressure.*

CONSTRUCTION AND MATERIALS

- *Body housing and cap support the internal ceramic parts.*
- *Ceramic internals are lining, orifice plate and multi-slotted core. The ceramic resists corrosive and abrasive suspensions.*
- *Body and cap are supplied in Stainless Steel as standard.*
- *Cap is threaded Female BSPT.*
- *Other materials are available on a special order.*

ORDER EXAMPLE

3" CA 140 Stainless Steel.

Maximum Recommended Pressure: 14 Bar.G.



CAPACITY CHARTS

DIMENSIONS AND WEIGHTS

<i>Thread Size</i>	<i>Dimensions (mm)</i>		<i>Weight (kg)</i>
	<i>A</i>	<i>B Dia.</i>	
1"	93,7	50,8	0,9
1 1/4"	93,7	50,8	0,9
1 1/2"	104,8	63,5	2,4
2"	127,0	76,2	4,3
3"	158,8	114,3	6,2
4"	244,5	149,2	9,0

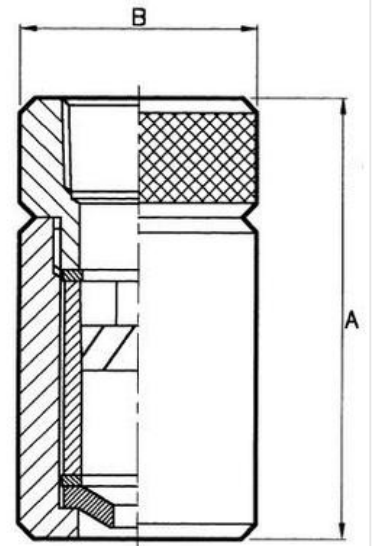

CAPACITY CHART

NOZZLE NUMBER	BSPT THREAD SIZE						FLOW RATE IN LITRES/MIN AT Bar.G.										SPRAY ANGLES (°) AT Bar.G.			
	1	1¼	1½	2	3	4	0,2	0,35	0,7	1	1,5	2	3	4	5,6	7	,35	,7	1,5	5,6
CA 12							24,0	35,5	4,7	54,6	65,7	74,8	86,9	94,8	106	115	55	60	65	45
CA 16							33,9	43,6	56,7	71,6	85,9	96,0	110	122	143	161	65	70	75	80
CA 20							43,6	56,1	78,1	96,4	113	126	145	162	188	213	65	70	75	50
CA 26							57,2	71,2	98,7	119,2	142	161	184	205	238	262	65	70	80	52
CA 22							46,0	59,7	83,8	102	123	138	162	178	207	225	55	60	60	50
CA 27							59,7	74,6	103	127	152	172	201	228	262	285	60	60	60	55
CA 32							71,9	89,5	124	150	180	202	228	260	294	319	70	70	70	60
CA 38							85,9	104	145	176	205	225	257	285	326	359	75	75	70	65
CA 43							91,8	115	166	200	232	255	291	330	373	404	80	85	80	70
CA 48							99,7	133	184	222	263	294	348	399	-	-	70	73	75	-
CA 58							121	161	222	258	307	344	400	449	-	-	71	77	79	-
CA 67							134	175	255	301	354	393	451	497	-	-	70	75	75	-
CA 76							157	204	289	343	409	458	526	574	-	-	85	85	85	-
CA 86							181	291	330	389	465	566	595	631	-	-	88	88	89	-
CA 91							193	253	348	418	501	567	654	718	-	-	94	94	94	-
CA 86							191	241	330	397	468	510	-	-	-	-	70	73	75	-
CA 113							247	310	431	512	593	605	-	-	-	-	80	83	85	-
CA 140							304	386	537	618	737	788	-	-	-	-	85	87	90	-
CA 167							368	464	638	758	895	974	-	-	-	-	90	93	95	-
CA 180							390	487	689	826	941	1030	-	-	-	-	95	95	95	-
CA 111							255	312	425	527	621	707	-	-	-	-	45	47	50	-
CA 166							368	469	633	758	919	1091	-	-	-	-	55	55	55	-
CA 222							501	633	849	1040	1263	1535	-	-	-	-	65	67	70	-
CA 300							675	835	1151	1364	1717	2020	-	-	-	-	80	83	85	-
CA 430							927	1182	1646	2030	2495	2969	-	-	-	-	95	96	98	-